

## Clock Adjustment

- Press and hold the M button for around 3 seconds. The minutes display (top left in the display) flashes.
- Change this value using the + and - buttons.
- Press the M button. The hour display (top left in the display) flashes.
- Change this value using the + and - buttons.
- Press the M button. The day display (top left in the display) will flash as a number.
- Change this value using the + and - buttons. Use 1 for Monday, 2 for Tuesday, 3 for Wednesday, 4 for Thursday, 5 for Friday, 6 for Saturday and 7 for Sunday.

## Temp. Calibration & IP Address Setting

I. Temp. Calibration: Turn thermostat off, then press M button for 3 sec. to calibrate Temp. by pressing "+" and "-" buttons. Range: -8°C ~8°C

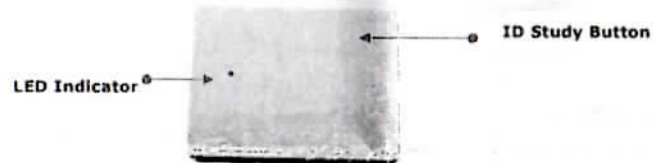

II. IP address :

- 1<sup>st</sup> Press the ID study button on the receiver, Green LED light blinking.
- 2<sup>nd</sup> Turn thermostat off, long press M buttons for 3 sec. The screen show a series number, then press M button again a BUZZ voice occurs, the green light stops blinking, IP address shows on the LCD display, the transmitter and receiver finish pairing.

If you have two or more receivers, the second or more receivers do the same steps to make IP address setting.

The transmitter can control the two or more receivers at same time.

## Wiring Diagram

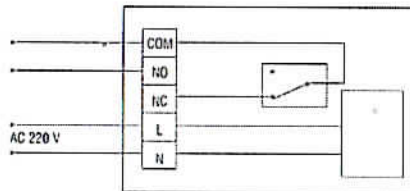

## Dimensions

Transmitter:

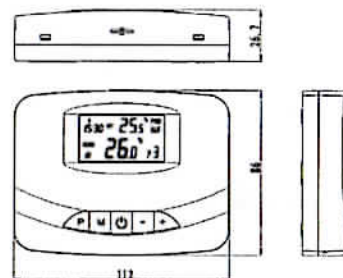

Receiver:

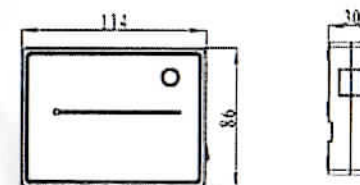

## Installation

(1) Mounting Method:

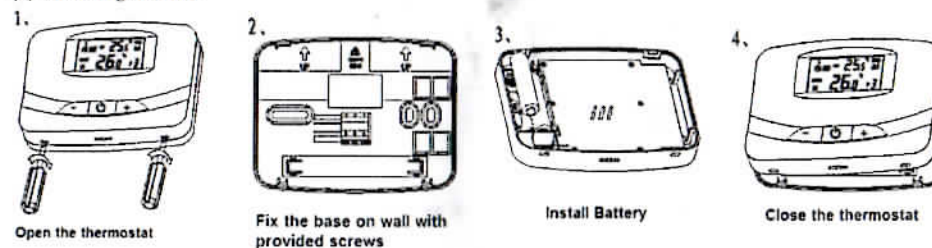

(2) Put on desk

